



FLY SCREEN

SLIDING

HOW TO INSTALL

WARNING

Introduction

We ask that you carefully read the contents of this document and keep it.

This manual is an essential part of the fly screen and to provide all the information necessary for its installation, use and maintenance.

The instructions, drawings and documents contained in this manual are of a technical nature.

Security

Screens are designed to protect from insects, rodents and small reptiles and not to ensure safety or prevent people or objects from entering. Fly screens do not prevent a child from falling out of a window.

In situations of poor visibility and for people with vision difficulties, the screen may not be identified, in these cases colored markings should be made to make the screen visible.

Do not remove product labels or CE mark.

The company reserves the right to make partial or total changes to the product without prior notice and refuses any responsibility for incorrect data.

The company will not respond to interventions carried out by third parties who, without prior notice, tamper with and/or alter the product.

Use

The fly screen should slide freely on the window frame, simply push or pull to open or close the fly screen.

Maintenance

Only carry out the indicated maintenance operations.

When exposed to external environmental conditions, the network does not favor the growth of microorganisms.

To clean the outside of the fly screens use blue and white soap or neutral detergent and water with a soft, damp sponge.

You must use the fly screen at least once every three months to prevent the mechanisms from getting stuck.



REQUIRED MATERIAL





INSTALLATION

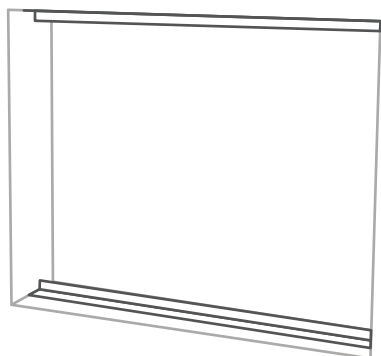

If the fly screen requires angles or U-shaped rails, apply the 30x30 mm angle in the upper span and the 20x20 mm angle in the lower span or one of the U-shaped rails at the top and the other at the bottom.

Recommendation

If the installation is carried out on masonry walls, the angle or gutter must be screwed.

If installation is done on stone, you can use 1mm double-sided tape to prevent drilling.

1

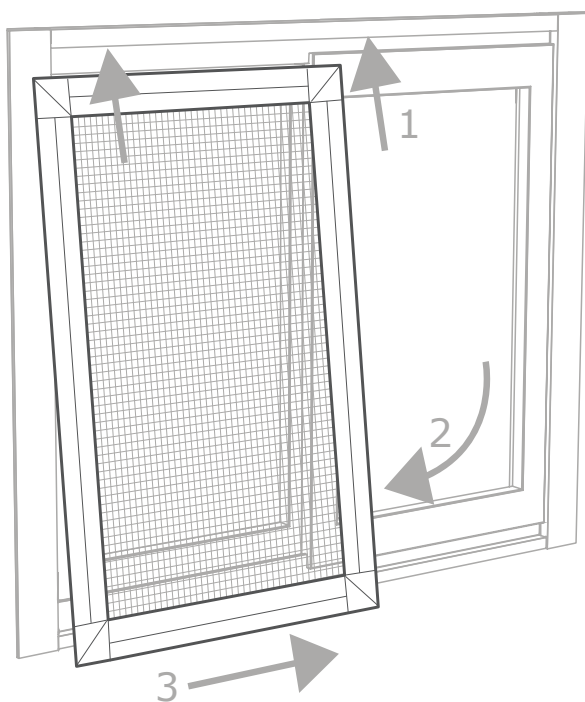

The sliding fly screen is very simple to install. It is first placed from the bottom up (1), fits into the bottom part (2) and moves from side to side (3) to confirm that it fits the window correctly.

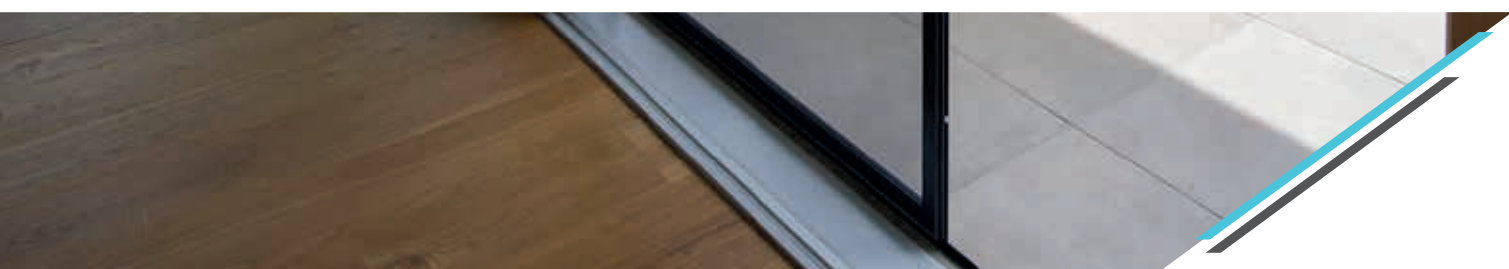



INSTALLATION

2

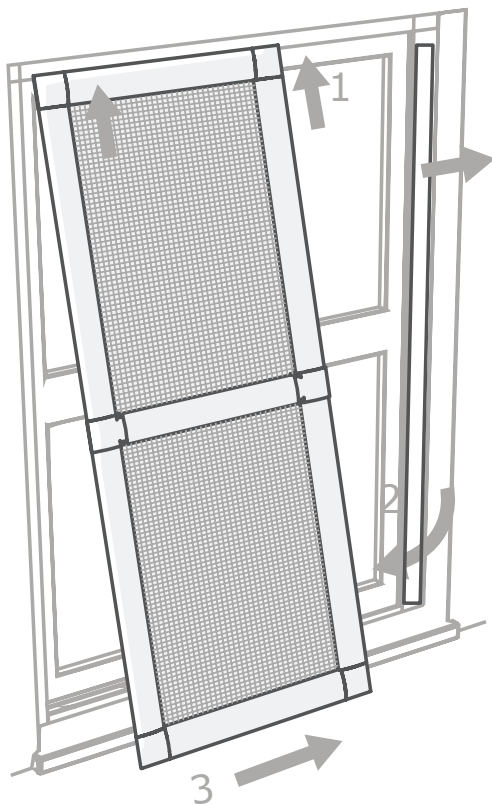

rail 14x20

The sliding fly screen, measuring more than 1500mm in height, has a reinforcement profile in the middle and a 14x20 side rail against the gap.

It is very simple to install. First, place the side rail against the gap with the recommended measurements and then first place it from the bottom up (1), fit it into the bottom part (2) and move it from side to side (3) to confirm that it rotates in the window correctly.

